

Samson® Material Feeder MF0814T

SAMSON
AUMUNDGROUP

CONTENT

3	Material Feeder MF0814T
4	Terminology Material Feeder Body
5	Chassis Optional Equipment
6	Side Elevation (Standard Unit) Side Elevation (with options) Rear Elevations
7	Plan Elevation (Standard Unit) Plan Elevation (with options) Performance Data
8	Loading with Wheel Loaders Loading with ADT's Loading with Road Tipping Trucks
9	Ship Loader Feeding Control Equipment
10	Powering the Machine Ease of Maintenance
11	After Sales and Services

Samson® Material Feeder

The SAMSON MF0814T is designed to receive bulk materials with a density of 1.4 - 2.2 t/m³ direct from dump trucks and front end loaders, providing a buffer holding capacity of up to 34 m³ and a regulated output feed rate of up to 733 m³ per hour direct to a mobile crushing, screening or other processing plant.

Undercarriage

The MF0814T is mounted on a tracked subframe coupled to heavy duty 600 mm wide by 4.8 m long tracks.

Power pack

Both the feeder and tracks are driven by a CAT C 6.6 diesel engine via variable displacement hydraulic pumps.

Loading section

Horizontal loading section with flared entry allows greater flexibility in truck alignment and maximises holding capacity while minimising the truck access ramp. Material can be received direct from the trucks or wide bucket front end loaders.

Conveyor Design

2.6 m wide 5 Ply belt supported by unique high performance, Trapezoidal form, load bearing double apron bars located on every pitch of the heavy duty conveyor chain.

Material discharge rate

Regulated volumetric material discharge is controlled by a combination of an adjustable blade and material feeder (MF) belt speed.

Controls

A control panel provides proportional speed control and an indicator light that the downstream equipment is ready to receive material. Tracking is controlled by means of an umbilical cord mounted handheld remote control.

Features

Hydraulic drives comprising a direct-coupled hydraulic motor with shaft mounted helical bevel reduction gear at either side of the shaft. Each drive is controlled by control valves mounted within the power pack. Unique design of adjustable double blade pivoting belt cleaner with additional wiper blade to rear chute elevation ensures minimal material on the return belt. Audible visual alarm for start-up and tracking modes. Dog lead pendant remote control.



Material Feeder MF0814T

SAMSON Materials Handling have built their success around the Material Feeder over a 40 year evolution.

Key Features

- Apron feeder design
- Equipped with caterpillar tracks
- Self propelled with Diesel/Hydraulic Drive
- Huge storage holding capacity
- Unrivalled varieties of materials handled
- Huge throughput and controlled discharge rate

The Samson® Material Feeder remains the optimum solution for customers who require a mobile solution to receive general bulk materials where fixed plant is not a viable option. Now available on tracks, this unit comes with unrivalled manoeuvrability.

Benefits

- Combines unrivalled strength of steel apron feeder with cleanliness of a belt feeder
- Well distributed ground pressure for excellent controllability on all types of surface
- Unrivalled manoeuvrability
- 100 t design feeding load, 65 t travel load – buffer holding capacity up to 34 m³
- Designed to handle dry, dusty, wet or sticky materials, scrap and shredded waste
- Configured specifically for mining & quarrying

Material Feeder MF0814T

Terminology

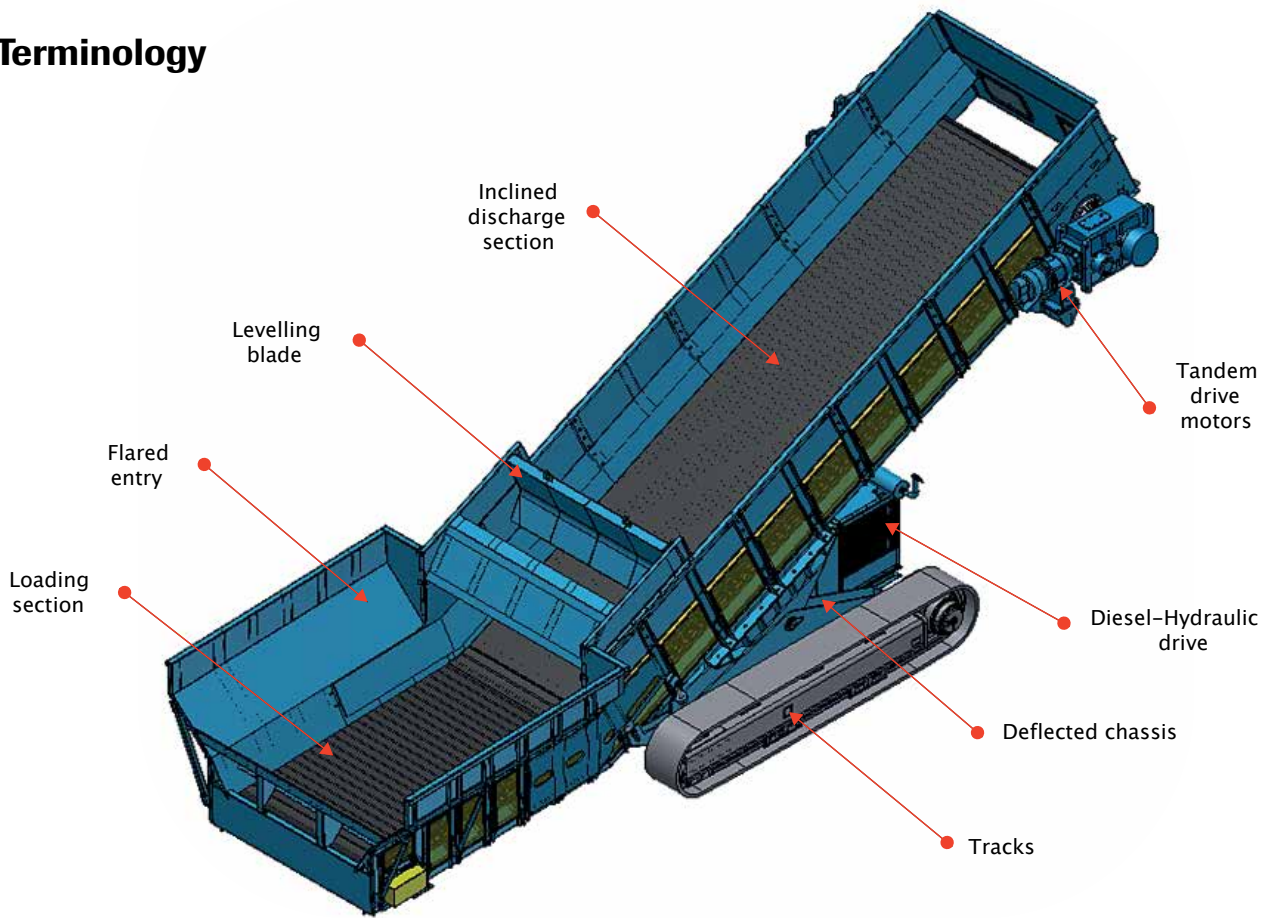

Material Feeder Body

- Belt rotation sensor fitted as standard

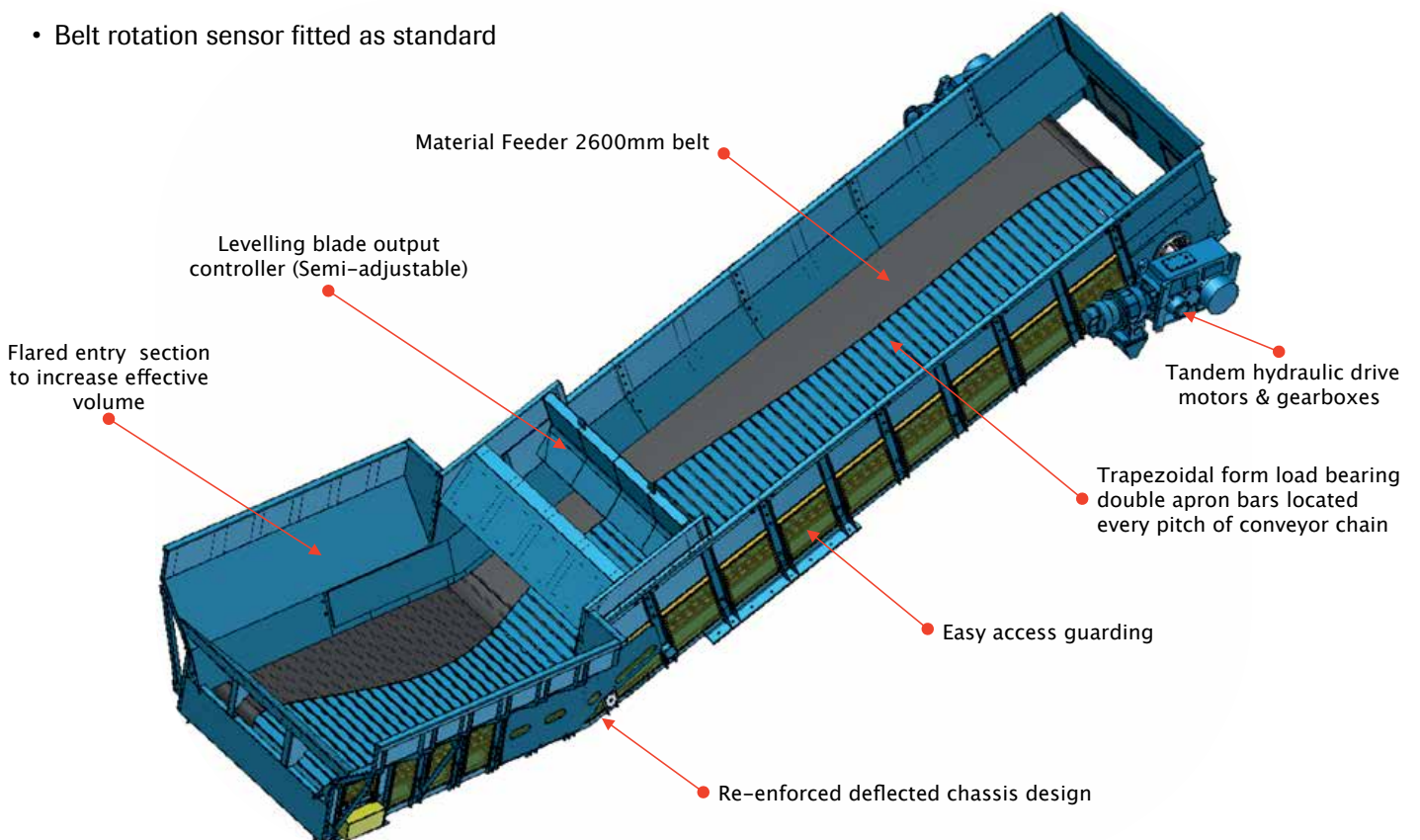

Chassis

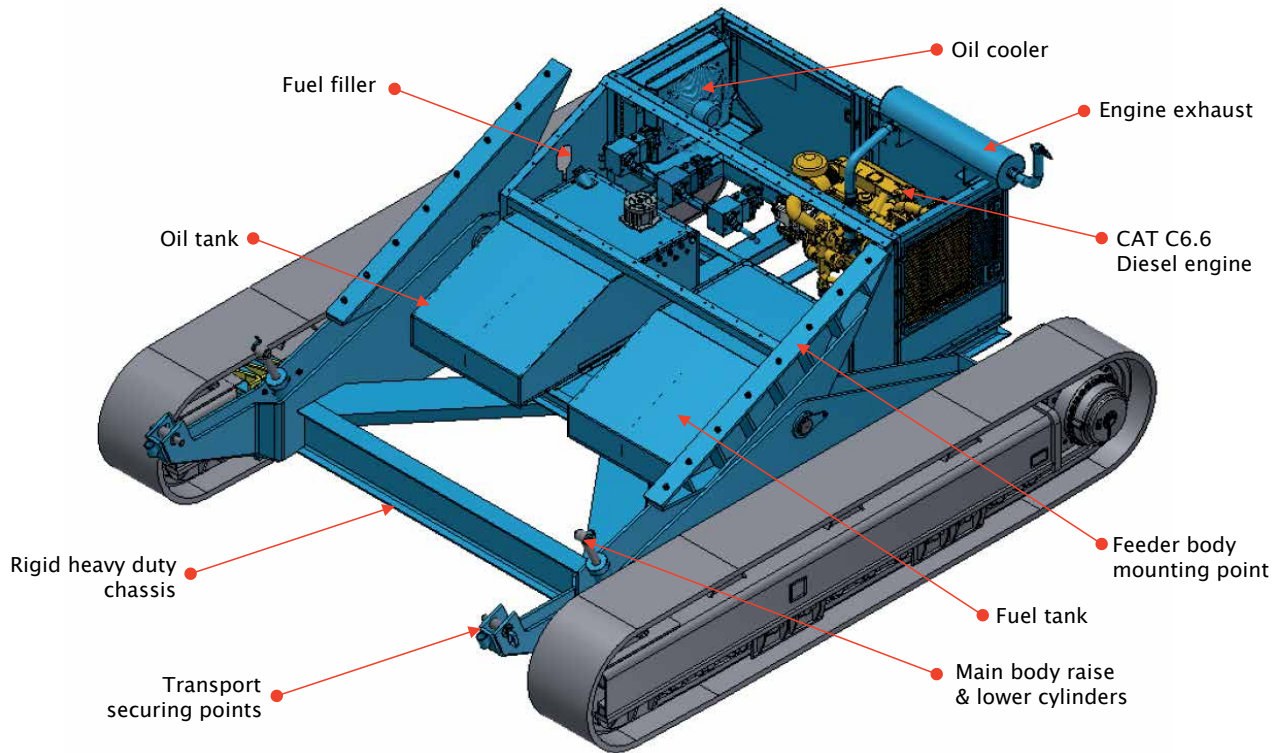

Optional Equipment

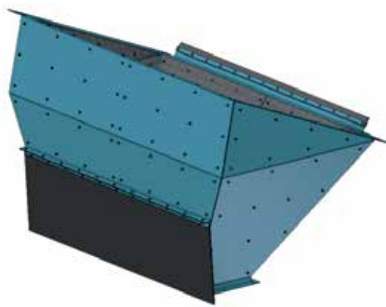

Integral head chute centralised design

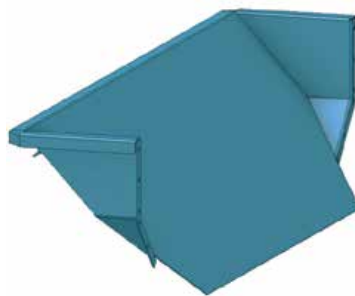

Loading section extension for side feeding



Integral head chute with vibrating reject grille

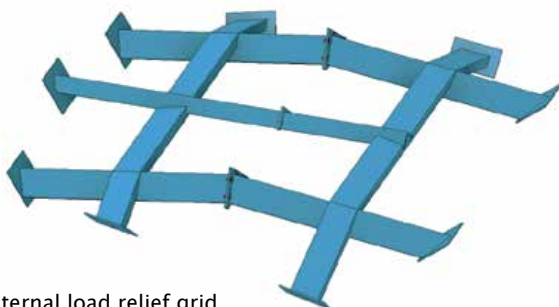

Internal load relief grid

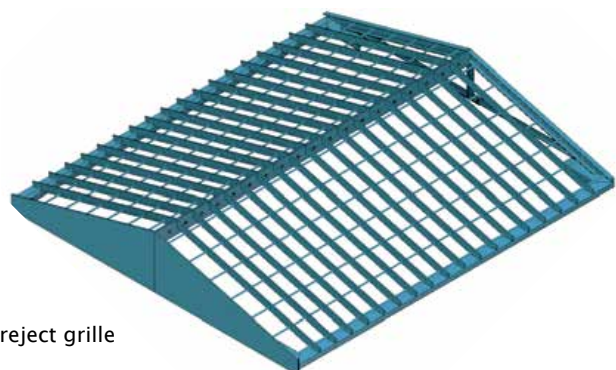

Inlet reject grille

Side Elevation (Standard Unit)

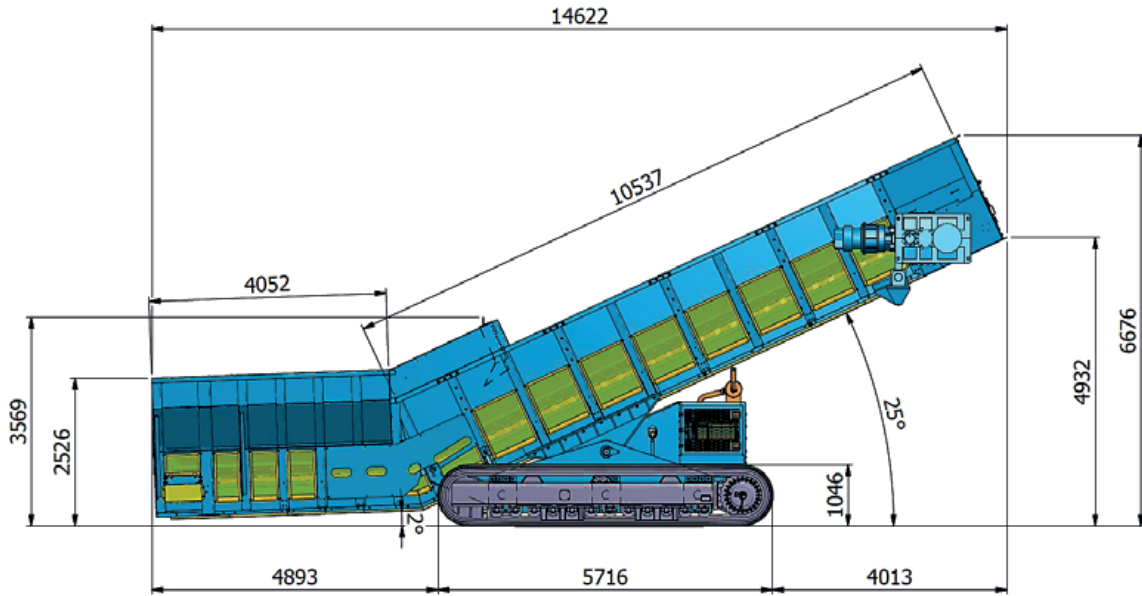

Side Elevation (with options)

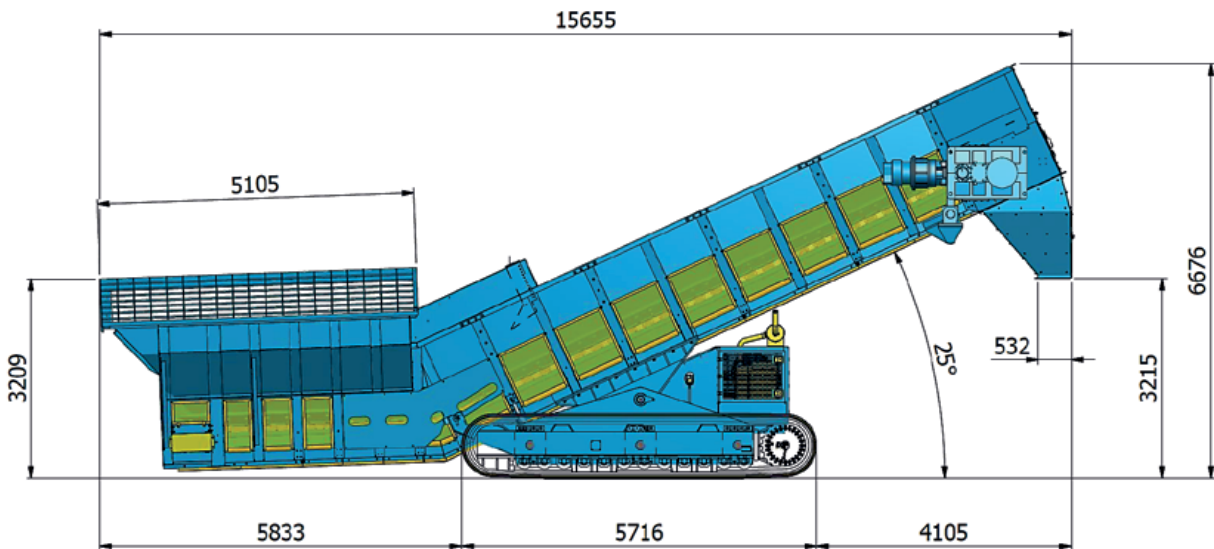

Rear Elevations

Standard Unit

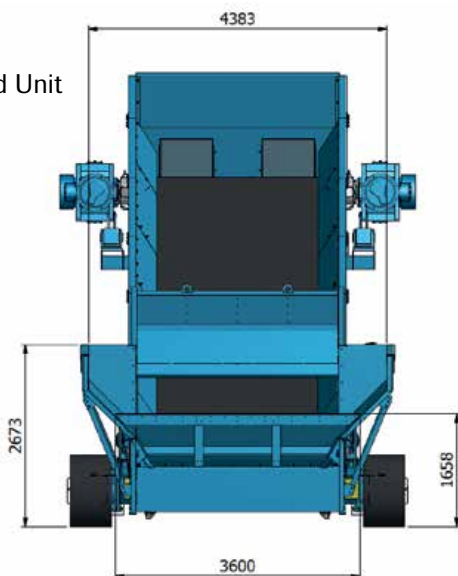

With Options

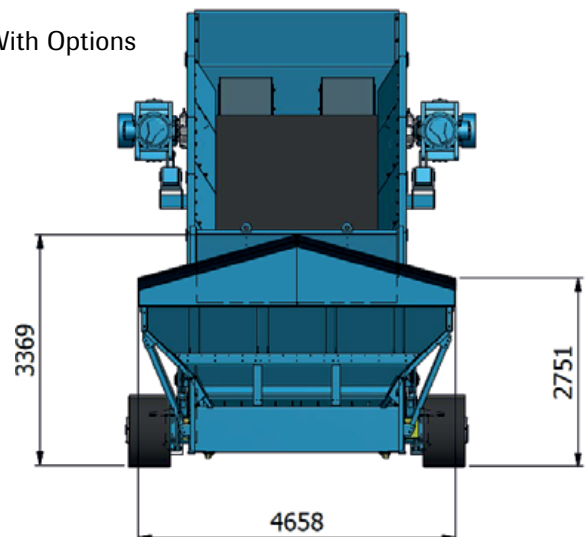

Plan Elevation (Standard Unit)

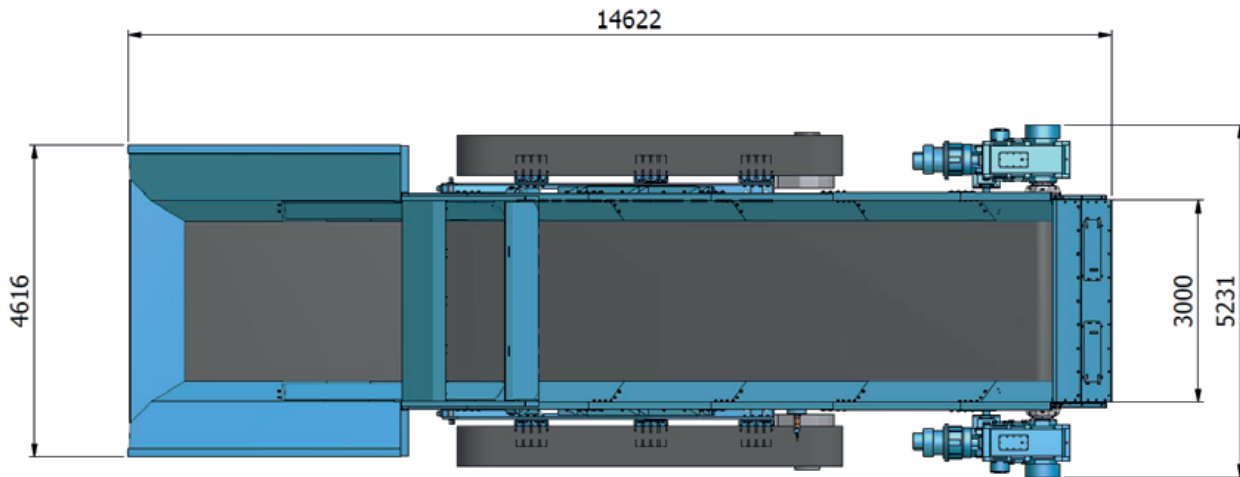

Plan Elevation (with options)

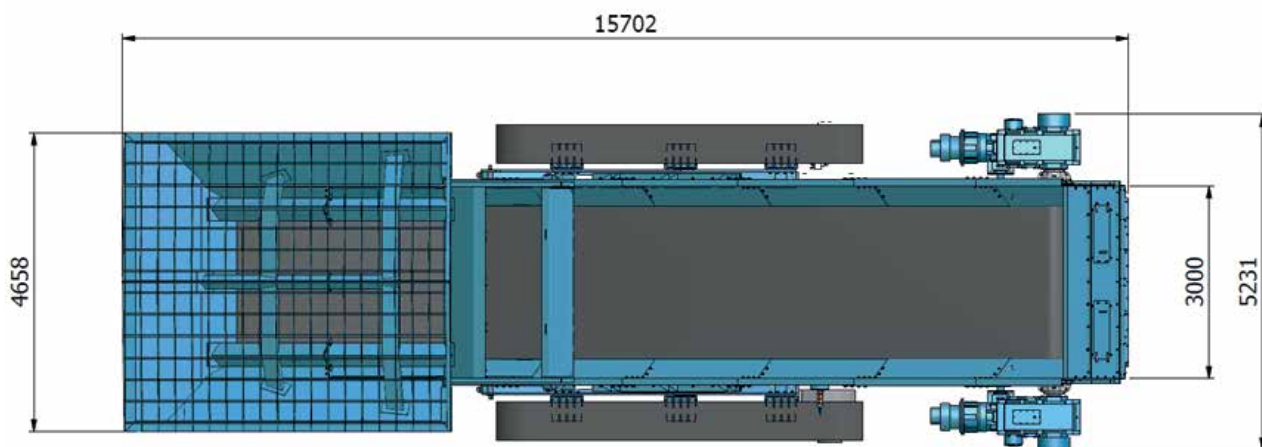

Performance Data



Typical materials

- Mineral ores
- Sand
- Rock Sized Material
- Coal
- Coke
- Aggregates

Maximum density: 2.2 t/m³
 Lump Size: 200 mm (10%)
 Capacity: 659 m³/h

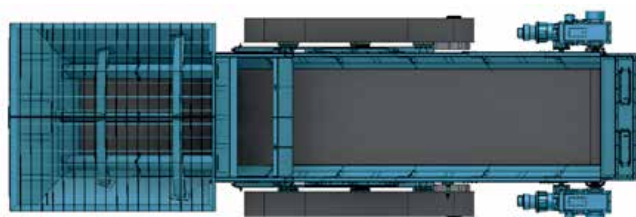

Loading with Wheel Loaders

Wheel Loaders

- Recommended maximum bucket: 4.5 m wide
- Recommended max volume: 8 m³

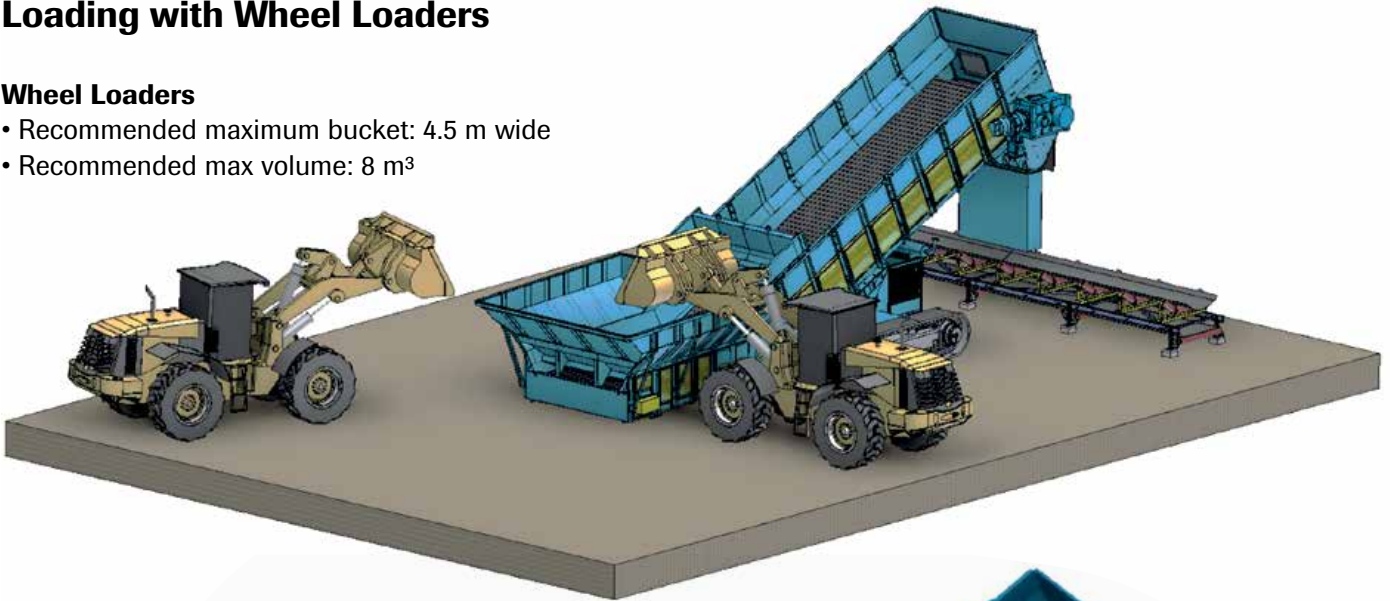

Loading with ADT's

Articulated Dump Trucks

- Recommended 35 tonnes capacity

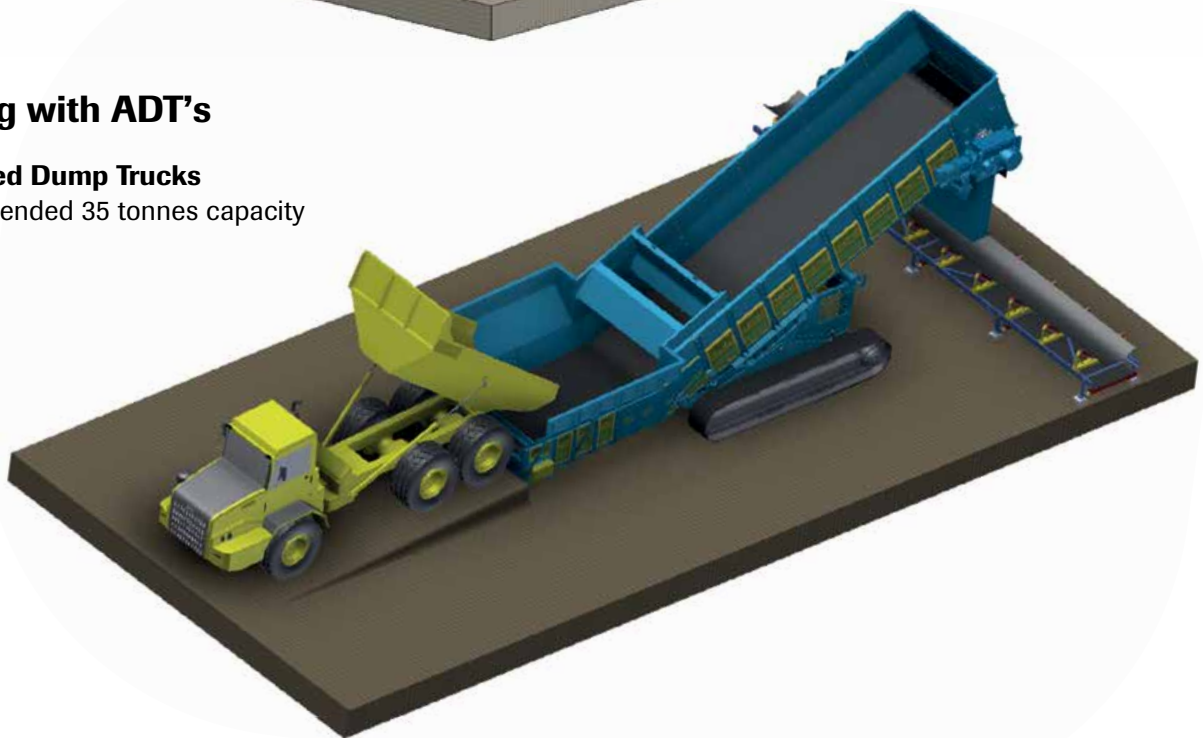

Loading with Road Tipping Trucks

Road Tipping Trucks

- Recommended 25/30 tonne trailers



Ship Loader Feeding



Twin MF0814T's feeding SL1445WP
 Material: Iron Ore
 Combined feed rate: 2600TPH



Control Equipment

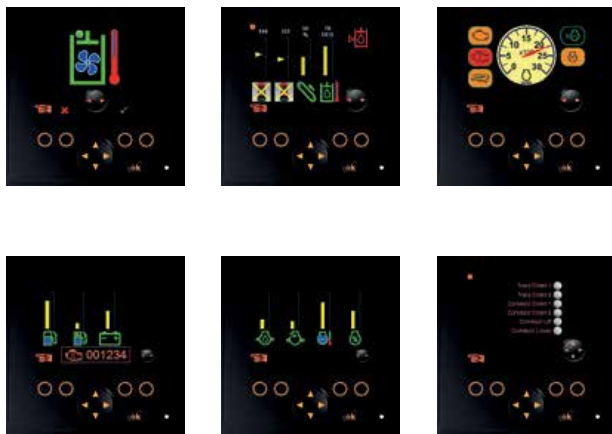

PLC Control System specially designed for mobile equipment. Complete with screen display for diagnostics

Full compliance Emergency Stops

- Control panel box
- Rear left entry section
- Rear right entry section
- Radio remote

Optional emergency pull cords can also be installed on each side of the machine



6 m 'Dog Lead' Remote Control

Powering the Machine

Electrical control system
BSEN 60204 Safety
Compliant
IP65 Protection

Hydraulic circuitry
CE Compliant
ISO4413 Designed & tested

900 litre
capacity
oil tank

CAT C6.6
tier 3 diesel engine

900 litre
Capacity diesel tank

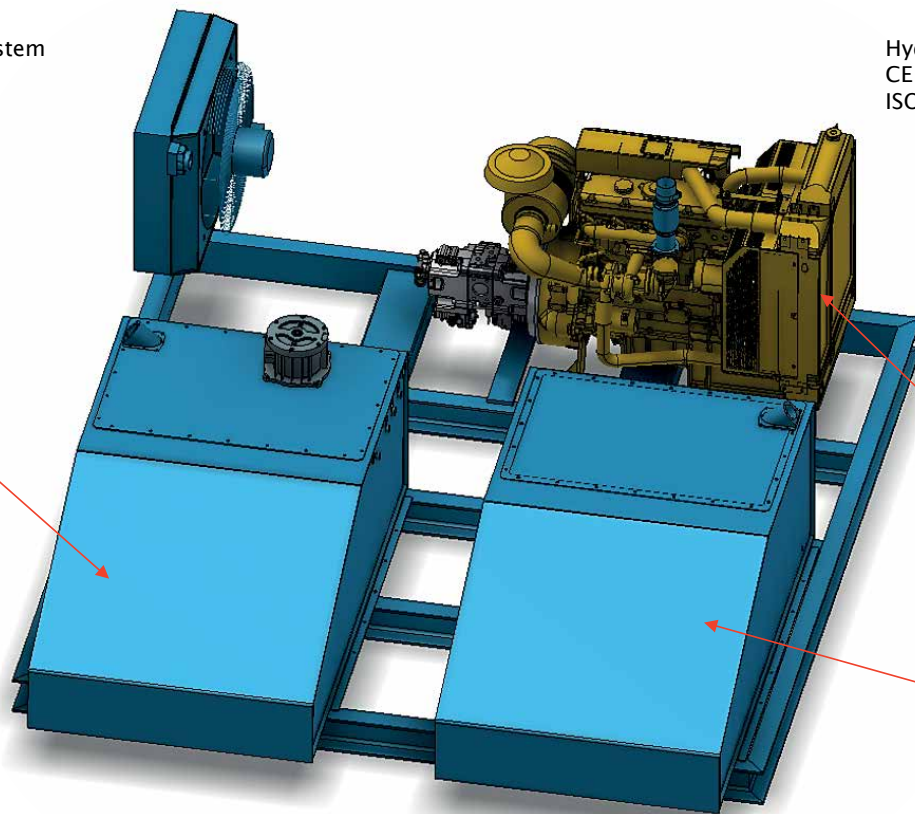

Ease of Maintenance

Maintenance points easily accessible

- Engine checks
- Hydraulic equipment checks
- Fluid levels
- Mechanical checks
- Lubrication points
- Safety checks

Maintenance frequency

- Weekly
- Monthly
- Three monthly



After Sales and Services

SAMSON Materials Handling Ltd. strive to deliver the highest standards of customer support and after sales service worldwide with the collaboration of the local AUMUND Group daughter companies and representative offices and including:

- Application advice
- Port or Plant Infrastructure Survey
- Performance and Selection Criteria
- Operational Guidance
- Machine Selection and Specification
- Supervision of Site Assembly
- Commissioning
- Advice on Maintenance Programmes
- Rebuilding and Refurbishment
- Genuine Spare Parts
- Service Contracts

Our engineers are highly trained and experienced in the SAMSON Materials Handling products and familiar with port operations and the demands of shipping schedules where equipment availability is critical to avoid demurrage costs.



THE AUMUND GROUP

GERMANY

AUMUND Fördertechnik GmbH

Saalhoffer Str. 17
47495 Rheinberg
Phone: +49 - 2843 - 72 0
Fax: +49 - 2843 - 6 02 70
e-mail: aumund@aumund.de
www.aumund.com

AUMUND Logistic GmbH

Saalhoffer Str. 17
47495 Rheinberg
Phone: +49 - 2843 - 72 0
Fax: +49 - 2843 - 7 24 73
e-mail: logistic@aumund.de
www.aumund.com

SCHADE Lagertechnik GmbH

Dorstener Straße 360
44653 Herne
Phone: +49 - 2325 - 58 74 0
Fax: +49 - 2325 - 58 74 74
e-mail:
info@schade-lagertechnik.de
www.schade-lagertechnik.com

GREAT BRITAIN

SAMSON Materials Handling Ltd.

Gemini House Cambridgeshire
Business Park, 1 Bartholomew's Walk
Ely, Cambridgeshire CB7 4EA
Phone: +44 - 1353 - 665 001
Fax: +44 - 1353 - 666 734
e-mail: sales@samson-mh.com
www.samson-mh.com

INDIA

AUMUND Engineering Private Ltd.

2nd Floor, Lakshmi Neela Rite Choice
Chambers · 9, Bazulla Road,
T. Nagar Chennai - 600 017
Phone: +91 - 44 - 4393 63 00
Fax: +91 - 44 - 2815 60 46
e-mail: aumund@vsnl.com

HONG KONG SAR

AUMUND Asia (H.K.) Limited

Unit 3B & 5, 30/F.
148 Electric Road
North Point
Hong Kong
Phone: +852 - 3695 - 43 33
Fax: +852 - 3695 - 43 11
e-mail: info@aumund-asia.com

DUBAI U.A.E.

AUMUND Fördertechnik GmbH Representative Office

P.O. Box 35291
Dubai, UAE
Phone: +971 - 4 - 2823762
e-mail: catalina@aumund.com

THE NETHERLANDS

AUMUND Holding B.V.

Wilhelminapark 40
5911 EE Venlo
Phone: +31 - 77 - 320 01 11
Fax: +31 - 77 - 320 07 28
e-mail: info@aumund-holding.nl

SWITZERLAND

AUMUND AG

Arther Str. 3
6301 Zug
Phone: +41 - 41 - 710 10 82
Fax: +41 - 41 - 710 42 02
e-mail: info@aumund.ch

RUSSIA

AUMUND Representative Office

German-Russian House, Office 44
ul. Malaja Pirogovskaja 5
119435 Moscow / Russia
Phone: +7 - 495 - 287 90 02
Fax: +7 - 495 - 287 90 06
e-mail: info@aumund.ru

FRANCE

AUMUND France S.A.R.L.

43, rue de Trévisse · F 75009 Paris
Phone: +33 - 1 - 42 46 72 72
Fax: +33 - 1 - 42 46 72 74
e-mail: aumund@aumund.fr

BRAZIL

AUMUND Ltda.

Avenida Eng. Luis Carlos Berrini
716 - 4.andar - conj. 41
04571-000 - São Paulo / SP
Phone: +55 - 11 - 3059 0160
Fax: +55 - 11 - 3059 0161
e-mail: aumund@aumund.com.br

USA

AUMUND Corporation

1825 Barrett Lakes Boulevard
Barrett Lakes Center II
Suite 520
Kennesaw, GA 30144
Phone: +1 - 770 - 226 - 95 78
Fax: +1 - 770 - 953 - 48 44
e-mail: sales@aumundusa.com

P.R. CHINA

AUMUND Machinery Trading (Beijing) Co. Ltd.

Rm. 7-8, 22-F, East Ocean Centre
No. 24 Jianguomenwai Avenue
Chaoyang District
Beijing 100004
Phone: +86 - 10 - 65 15 58 13 / 14
Fax: +86 - 10 - 65 15 58 15
e-mail: aumund@aumund.cn



SAMSON office building Ely, U.K.

AUMUND GROUP Headquarters in Rheinberg, Germany

SAMSON

AUMUNDGROUP

Dedicated to providing the most comprehensive range of mobile solutions for bulk materials handling in Ports and Terminals, Mining, Environmental, Cement, Foodstuffs, Agriculture and Power.

Built around the unique concept of the Samson® Material Feeder, SAMSON Materials Handling offer flexibility, reliability, quality, and industry leading performance from truck intake right through to mobile stacking and ship loading solution.

SAMSON Materials Handling Ltd.
Gemini House, Cambridgeshire Business Park, 1 Bartholomew's Walk, Ely, Cambridgeshire CB7 4EA, England
Tel.: +44-1353-665001 • Fax: +44-1353-666734 • e-mail: sales@samson-mh.com

www.samson-mh.com